



An Inclusive Community Facilitating Growth and Independence through Friendship

Build your legacy and help to bring Friendship House to Fayetteville

\$1.3 million in pledge commitments are needed to make Friendship House Fayetteville a reality.

WHAT IS FRIENDSHIP HOUSE?

Friendship House Fayetteville is an intentional living community that provides affordable, integrated housing for young adults with intellectual and developmental disabilities (I/DD) and healthcare professional students.

The concept of Friendship House was first established in Holland, Michigan on the campus of Western Theological Seminary. In the Spring of 2010, Duke Divinity School students and Reality Ministries replicated Friendship House in Durham, North Carolina. Today, ServiceSource North Carolina, in partnership with Highland Presbyterian Church, seeks to replicate a third Friendship House in Fayetteville, North Carolina.

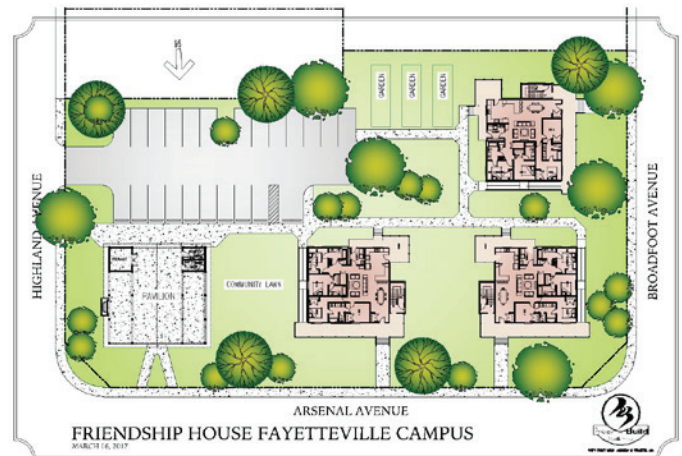

MISSION

Friendship House Fayetteville works alongside young adults with intellectual and developmental disabilities and their families to provide intentional, transitional living. At its core, this faith-based community is rooted in table fellowship expressed through a daily rhythm of eating, praying and celebrating together.

FRIENDSHIP HOUSE MODEL

Three homes will be constructed, each with two apartment floors. In each apartment floor, three students live with one "friend resident." Friend residents are young adults with I/DD who have lived at home with family supports. As a gateway to independent living, friend residents are expected to have part-time jobs or significant volunteer work and care for themselves. Residents live as roommates and friends. This model of

inclusive living brings education and awareness to both the students and friends. Students gain compassion in how they care for patients. Friends are empowered and gain independent living skills.

SUPPORTING PARTNERS

- ServiceSource North Carolina Regional Office
- Highland Presbyterian Church
- Duggins/Smith Companies

SUPPORTING ORGANIZATIONS

- Friendship House Partners, USA
- Campbell University
- Methodist University
- Fayetteville Technical Community College
- Fayetteville State University

Learn more and give online at: friendshiphousefayetteville.org

Build Your Legacy

Legacy Donors will have their name or dedication applied to designated areas of the facility. Build your legacy and be a part of this intentional, faith-based living community.

The following legacy donor naming opportunities are available:

Naming Opportunity	Gift Level
Campus.....	\$200,000
Pavilion.....	\$150,000
House (3 available).....	\$100,000
Apartment floor (6 available).....	\$50,000
Garden (3 available).....	\$25,000
Garden Bench (3 available).....	\$10,000
Donor wall.....	\$5,000-\$9,999
Brick.....	\$100

Become a Legacy Donor Today!

For more information, contact:

Tara Hinton

Email: Tara.Hinton@servicesource.org

Phone: 910-826-4699, ext: 249

OTHER GIVING OPTIONS

- I want to make a one-time gift in the amount of:
\$ _____
- I will make my gifts according to the following schedule:
Year 1: \$ _____ on _____
(Amount) (Date)
Year 2: \$ _____ on _____
(Amount) (Date)
Year 3: \$ _____ on _____
(Amount) (Date)
Year 4: \$ _____ on _____
(Amount) (Date)
Year 5: \$ _____ on _____
(Amount) (Date)

DONOR INFORMATION

Name: _____
(As it will appear in the campaign materials)

Company Name: _____

Position: _____

Home Address: _____

City: _____

State: _____ Zip Code: _____

Phone: _____

Email: _____

PAYMENT OPTIONS

ACH Payment

- Monthly (automatic withdrawal occurs on the 15th of each month)
 - Quarterly (automatic withdrawal occurs on the 15th of January, April, July and December)
 - Yearly (automatic withdrawal occurs on the 15th of November)
- Note:** An ACH must be set up with the Foundation on at least a yearly basis. Dates listed above are default dates; if you wish to modify your default dates please use the payment schedule on this form.

Check

- My first check is enclosed and subsequent check(s) will be sent according to the payment schedule listed.
Checks payable to: **Friendship House Fayetteville**

Credit Card

- Visa Master Card American Express

Card No: _____

Exp. Date _____ Security Code: _____

Name on card: _____

Billing Address: _____

Date: _____

Signature: _____



FRIENDSHIP HOUSE
FAYETTEVILLE

600 Ames Street, Fayetteville, NC 28304

Friendship House Fayetteville is a restricted fund of the ServiceSource Foundation. 100% of all donations to this fund will be directed to Friendship House Fayetteville.

ServiceSource Foundation is a 501(c)(3) organization as defined by the IRS. Gifts are tax deductible to the extent provided by law. Tax ID: 20-1438270.